

**TRAFFIC MANAGEMENT
PHASE 1**

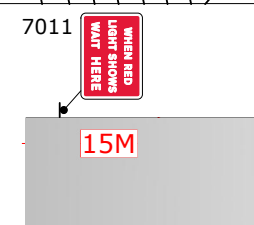
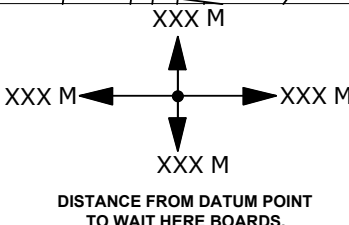
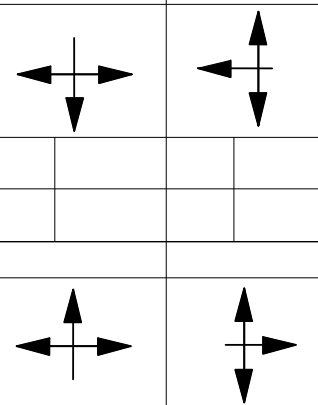
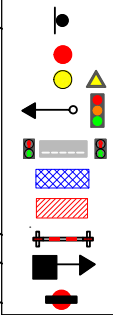
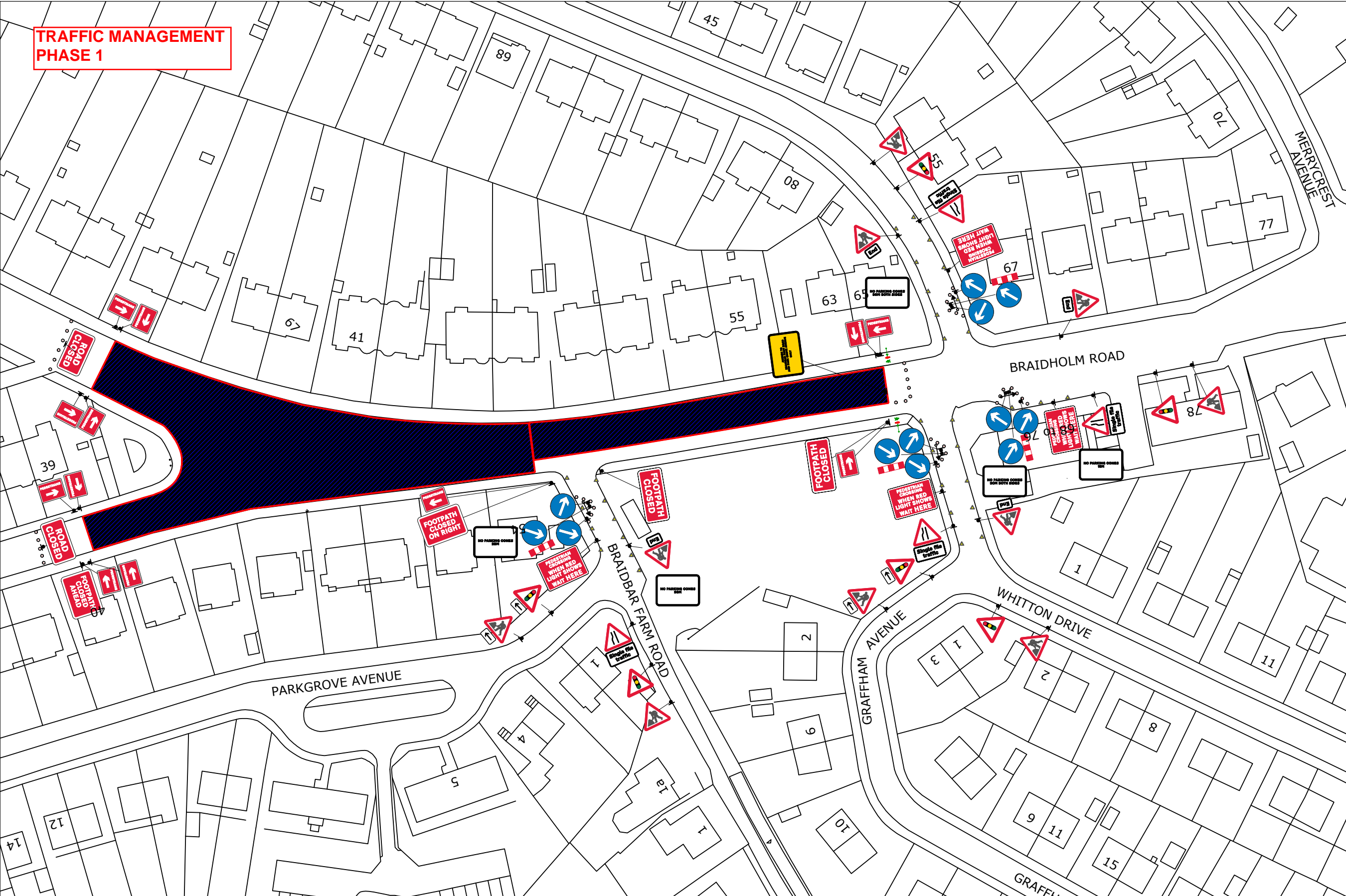
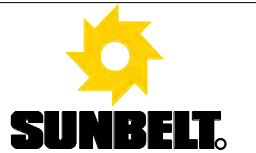

Note:
 1) This distance may have to be increased in some cases to allow larger vehicles to pass the works.
 2) Sign ref 7011 variants to be used for multiphase & pedestrian traffic signals.

DETAIL C1 (C1)

 Single/Dual carriageway 40mph or less - 750mm traffic cones.
 Single/Dual carriageway 50mph or more - 750mm traffic cones.
 Notes:
 1) During darkness, warning lights to BS EN 12352:2006 should be provided in accordance with Table A1.3 (Appendix 1).
 2) For relaxation to Detail C1 see Table A1.3 (Appendix 1).

DETAIL B (B)

 Single/Dual carriageway 50mph or more - 750mm traffic cones, spacing 1.5m.
 Dual carriageway national speed limit - 750mm traffic cones, spacing 1.5m, relaxation 3m.
 Notes:
 1) During darkness, warning lights to BS EN 12352:2006 should be provided in accordance with Table A1.3 (Appendix 1).
 2) 45° tapers have 1.2m spacing, no relaxations.
 3) On motorways and NSL AP duals with hard shoulders, 1m cones will be required for both standard and relaxation works for lead tapers and the facing wall of lane changes.

The information in this drawing may not be copied or used by third parties without written consent from Sunbelt Rentals Ltd (Traffic Management). This layout is for installation by NRSWA, Lantra 12A,12B,12C,12D qualified persons.
All works shall be in accordance with Safety at Street Works and Road Works, A Code of Practice 2013 & Chapter 8

THIS DOCUMENT IS UNCONTROLLED WHEN PRINTED

The electronic version of this document is the approved and most current. Any printed version is uncontrolled and may not be current.

**TRAFFIC MANAGEMENT
PHASE 2**

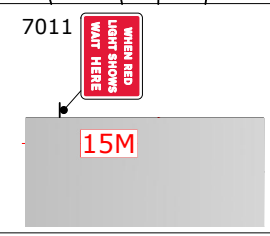
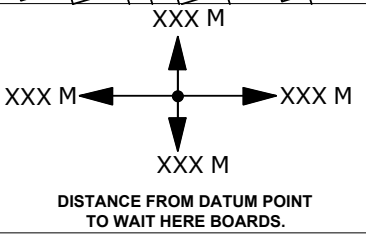
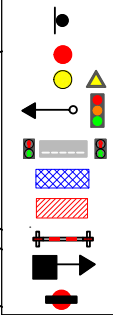
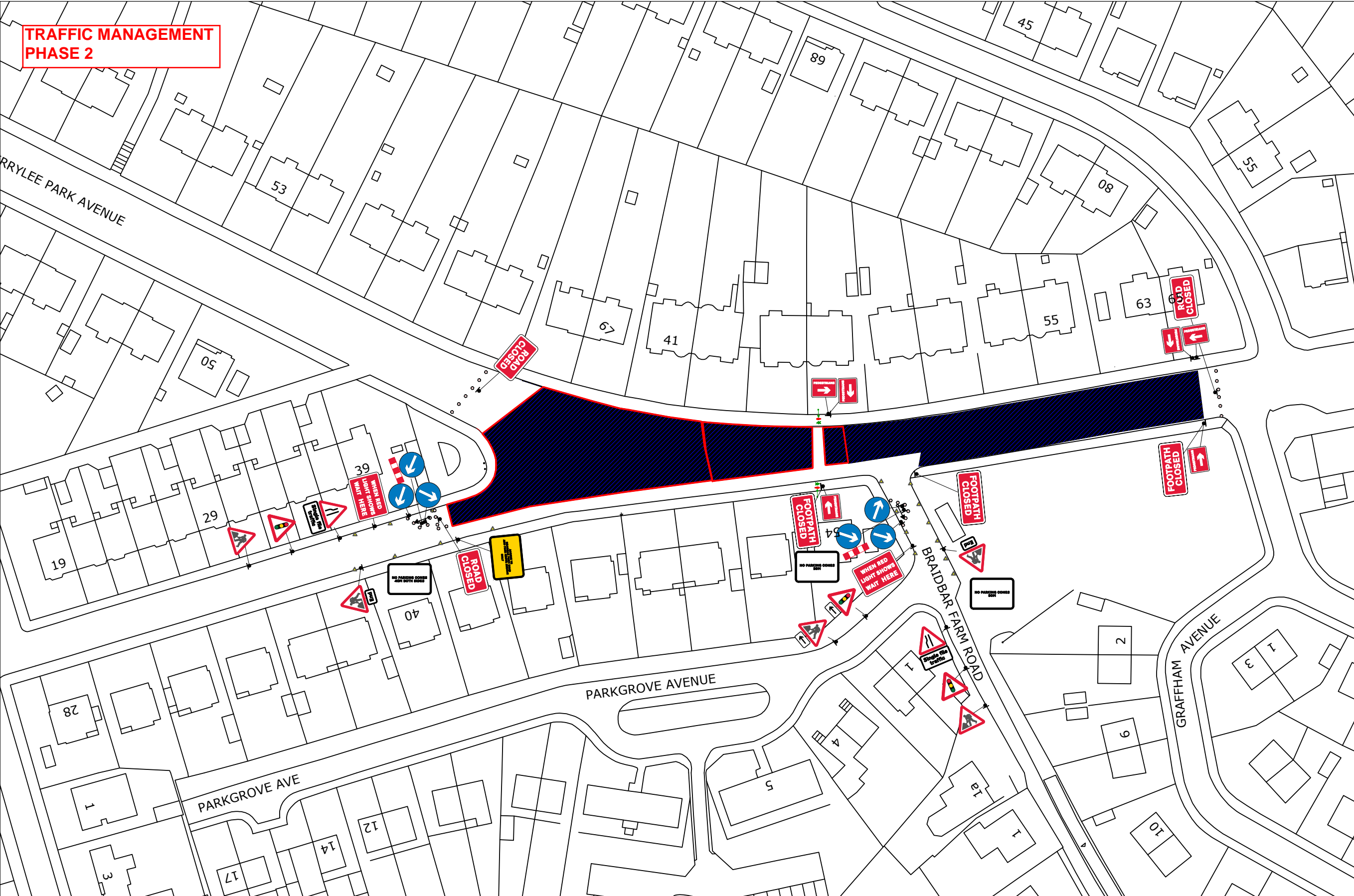
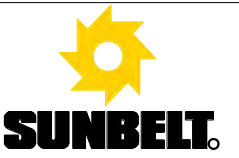

Note:
 1) This distance may have to be increased in some cases to allow larger vehicles to pass the works.
 2) Sign ref 7011 variants to be used for multiphase & pedestrian traffic signals.

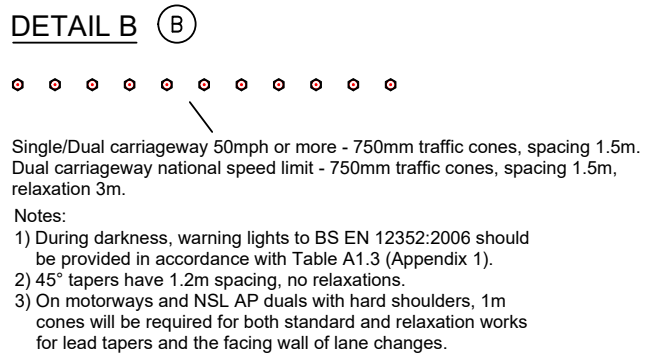
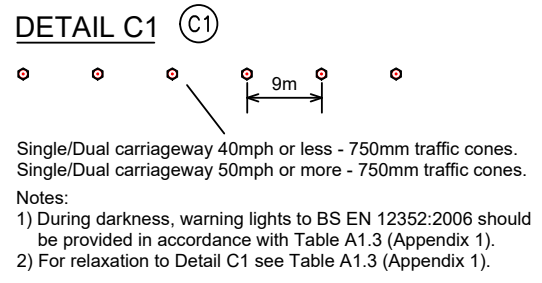

The information in this drawing may not be copied or used by third parties without written consent from Sunbelt Rentals Ltd (Traffic Management). This layout is for installation by NRSWA, Lantra 12A,12B,12C,12D qualified persons.
All works shall be in accordance with Safety at Street Works and Road Works, A Code of Practice 2013 & Chapter 8

THIS DOCUMENT IS UNCONTROLLED WHEN PRINTED

The electronic version of this document is the approved and most current. Any printed version is uncontrolled and may not be current.

KEY	01 		02	04 Diverted traffic	06 Diverted traffic	08 Diversion	10 ROAD AHEAD CLOSED	12 Diverted traffic	Diverted traffic	
01A Advanced Warning ROAD CLOSED HERE ON 00/00/00 FOR XX DAYS FROM 00.00 TO 00.00	ROAD CLOSED	Diversion ENDS	03	05 Diverted traffic	07 Diversion	09 Diversion	11 Diverted traffic	13 Diverted traffic	XXXXXXXXXXXX XXXXXXXXXXXX XXXXXXXXXXXX XXXXXXXXXXXX	

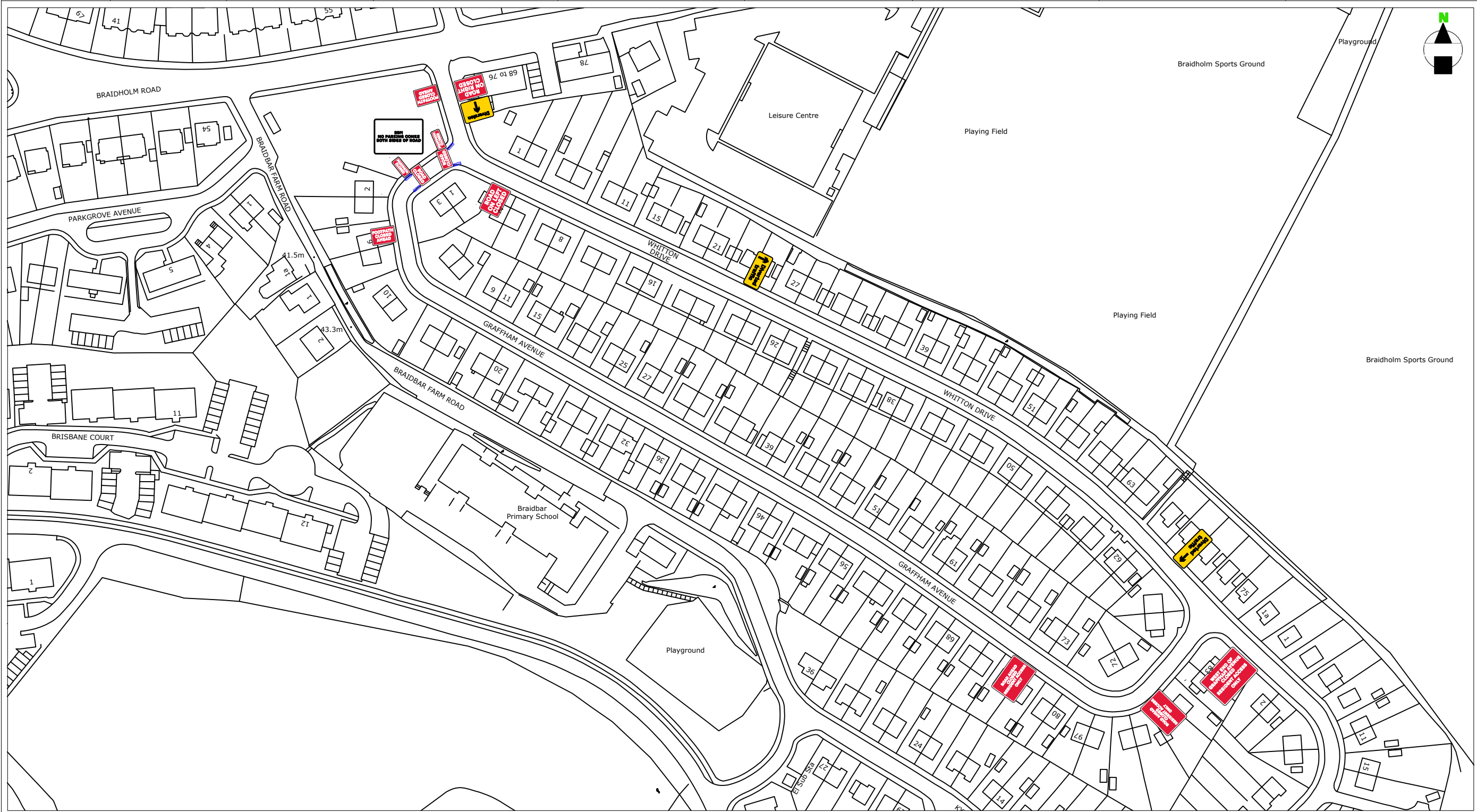

Contract No	19-05-22	Client:	GEORGE LESLIE
Date	19-05-22	Site Location / Drawing Title	GRAFFHAM AVENUE GIFFNOCK
Drawn by	GR		
Approved By	XXXXXXXXXX		
Purpose of works	ACCESS CONSTRUCTION		
DWG Version No	000		
Amended By	XXXXXXXXXX		
Amendment Date	xx/xx/xxxx	Scale	NOT TO SCALE
Sheet No	x of x	OS Licence No	000000000000

Note
 1. All equipment shall be approved and shall comply with the Department Of Transport specification MCE0111. This drawing does not show the normal road works signage that will be required as per Chapter 8.
 2. All signs to be in accordance with TSGRD 2016 and to minimum class retroreflective.
 3. Minimum height of lettering to be 60mm and sign boards to be 1000mm (750mm where appropriate).

The information in this drawing may not be copied or used by third parties without written consent from Sunbelt Rentals Ltd (Traffic Management).
 This layout is for installation by NRSWA, Lantra 12A,12B,12C,12D qualified persons.
 All works shall be in accordance with Safety at Street Works and Road Works, A Code of Practice 2013 & Chapter 8

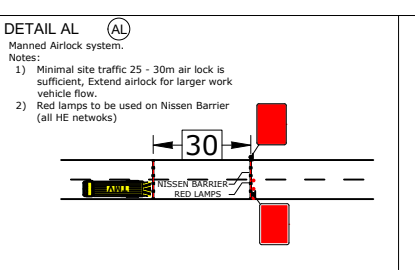
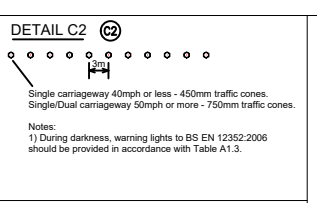
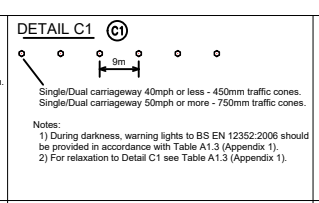
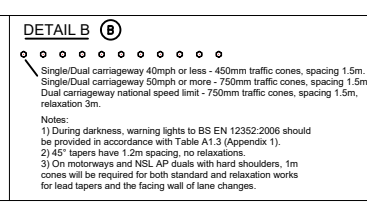

THIS DOCUMENT IS UNCONTROLLED WHEN PRINTED
 The electronic version of this document is the approved and most current. Any printed version is uncontrolled and may not be current.

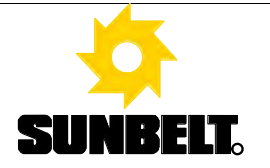

KEY	01 		02	Diverted traffic →	04	↑ Diverted traffic	06	← Diversion	08	ROAD AHEAD CLOSED	10	Diverted traffic	12	Diverted traffic	14	Diverted traffic	16
01A Advanced Warning ROAD CLOSED HERE ON 00/00/00 FOR XX DAYS FROM 00.00 TO 00.00	ROAD CLOSED	Diversion ENDS	03	← Diverted traffic	05	→ Diversion	07	↑ Diversion	09	Diverted traffic	11	Diverted traffic	13	Diverted traffic	15	XXXXXXXXXXXX XXXXXXXXXXXX XXXXXXXXXXXX XXXXXXXXXXXX	17

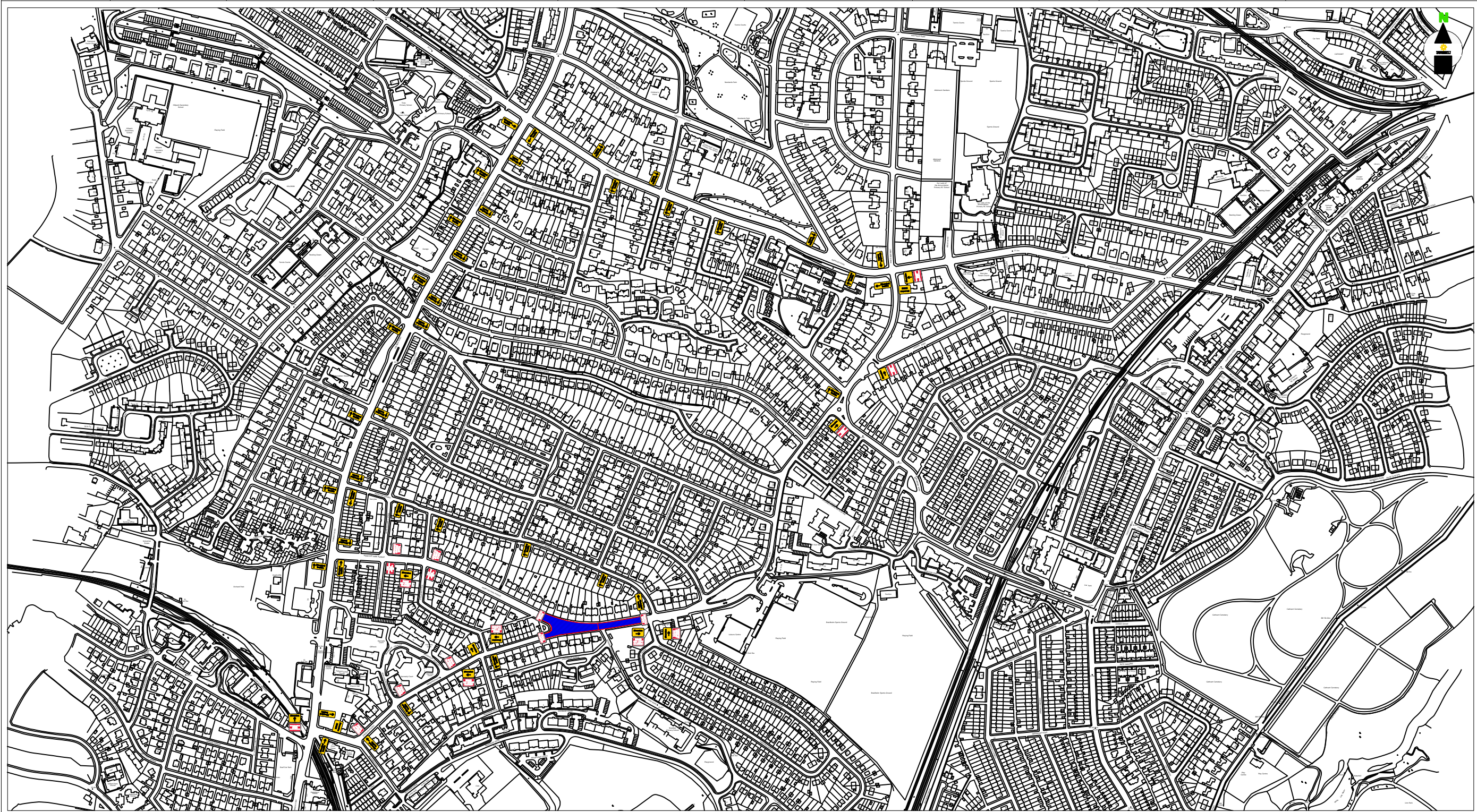

XXXXXXXXXXXX XXXXXXXXXXXX XXXXXXXXXXXX XXXXXXXXXXXX	S1
XXXXXXXXXXXX XXXXXXXXXXXX XXXXXXXXXXXX XXXXXXXXXXXX	S2

Qty 1 Ref: 13.9 Schedule 13 Temporary Sign	
Qty 1 Ref: 12.1 Schedule 12 Temporary Sign	
Qty 2 Ref: 12.9 Schedule 12 Temporary Sign	
Qty 2 Ref: 13.9 Schedule 13 Temporary Sign	
Qty 2 Ref: 13.9 Schedule 13 Temporary Sign	
Qty 2 Ref: 2702 Head of temporary diversion route	
Qty 3 Ref: 2702 Head of temporary diversion route	
Qty 3 Ref: 2702 Head of temporary diversion route	
Qty 3 Ref: 2702 Direction of temporary diversion route from junction ahead	
Qty 3 Ref: 2702 Direction of temporary diversion route from junction ahead	
Qty 3 Ref: 2702 Direction of temporary diversion route from junction ahead	
Qty 6 Ref: 1003.1 Notice of temporary road ahead - Road Ahead Closed	
Qty 6 Ref: 1003.1 Notice of temporary road ahead - Road Closed	

ROAD CLOSURE LENGTH	150	meters
ROAD CLOSURE WIDTH		meters

Contract No	11-03-22	Client:	GEORGE LESLIE
Date	11-03-22	Site Location / Drawing Title	MERRYLEE PARK AVENUE BRAIDHOLM ROAD GIFFNOCK
Drawn by	GR		
Approved By	XXXXXXXXXX		
Purpose of works	CIVILS WORKS		
DWG Version No	000		
Amended By	XXXXXXXXXX		
Amendment Date	xx/xx/xxxx	Scale	NOT TO SCALE
Sheet No	x of x	OS Licence No	000000000000

Note
 1. All equipment shall be approved and shall comply with the Department Of Transport specification MCE0111. This drawing does not show the normal road works signage that will be required as per Chapter 8.
 2. All signs to be in accordance with TSGRD 2016 and to minimum class retroreflective.
 3. Minimum height of lettering to be 60mm and sign boards to be 1000mm (750mm where appropriate).

The information in this drawing may not be copied or used by third parties without written consent from Sunbelt Rentals Ltd (Traffic Management).
 This layout is for installation by NRSWA, Lantra 12A,12B,12C,12D qualified persons.
 All works shall be in accordance with Safety at Street Works and Road Works, A Code of Practice 2013 & Chapter 8

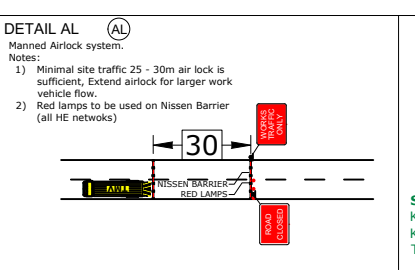
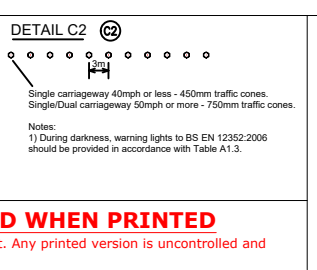
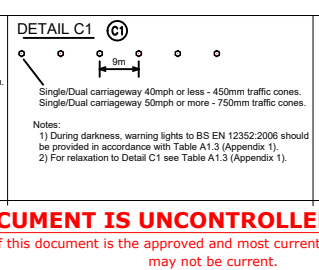
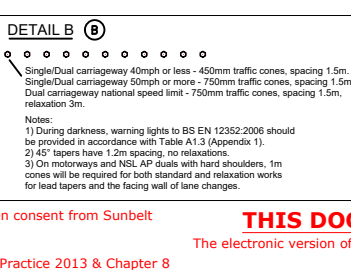

THIS DOCUMENT IS UNCONTROLLED WHEN PRINTED
 The electronic version of this document is the approved and most current. Any printed version is uncontrolled and may not be current.

SUNBELT RENTALS
 Sunbelt Rentals UK (Traffic Management)
 Kemble Airfield Enterprise Park, Cirencester Road,
 Kemble GL7 6BQ
 Telephone: 0370 050 0792

V9